

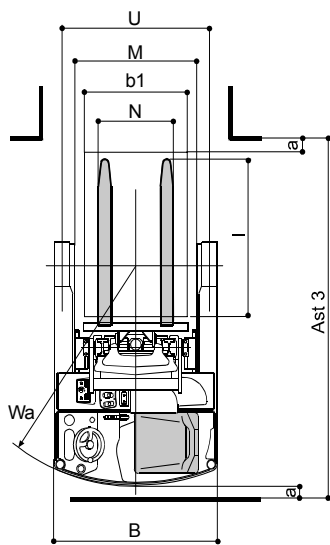

**CLARK EUROPE GMBH**  
 Neckarstrasse 37  
 D-45478 Mülheim an der Ruhr/Germany  
 Tel.: +49 208 377336-0  
 Fax: +49 208 377336-36  
 www.clarkmheu.com  
 info-europe@clarkmheu.com

1. Characteristics				
1.1	Manufacturer			CLARK
1.2	Model	Denomination of model in production		C RT14
1.3	Capacity	Q	nominal capacity	Kg. 1.400
1.4	Load center	c	distance to load center	mm 600
1.5	Power	E = Electric		E
1.6	Control	S = steering / R = rider		S / R
1.7	Service braking	M (mechanical)   (hydraulic)		M - I
1.8	Parking brake	( . ) pedal ( .. ) parking		( . ) ( .. )
2. Wheels				
2.1	Wheels type	vlk = vulkolan		vlk
2.2	Wheels	quantity (x=traction) front/rear	Nr.	1x 2
		front wheels size	mm	343
		rear wheels size	mm	300
3. Dimensions				
3.1	Mast	h5	full free lift for duplex mast (option)	mm /
		h3	lifting height	mm 6.000
		h2	standard free lift	mm /
		h5	full free lift triplex mast	mm 2.060
		h1	minimum height overall dimension	mm 2.615
		h4	maximum height overall dimension	mm 6.595
3.2	Forks holder plate	b1	width / Fem	mm 800 / II A
3.3	Forks	L/s	length (L) x width (b) x thcikness (s)	mm 1.150 x 100 x 35
3.4	Tilting	a/β	forward/backward	° 3 / 5
3.5	Max. dimensions	L2	length overall including forks face	mm 1.224
		B	width	mm 1.270
		h6	overall height overhead guard	mm 2.100
		h7	operators seat height from ground	mm 1.000
3.6	Wheel base	Y	wheel base	mm 1.346
3.7	Wheel base	at wheels center front/rear		mm - / 1.130
3.8	Clearance	chassis		mm 80
		outriggers		mm 70
3.9	Distance load	x	from load to front axle	mm 170
3.10	Turning radius	Wa	radius	mm 1.600
3.11	Stacking aisle	Ast3	with pallet (800x1.200 / 1.000x1.200)	mm 2.624
				mm
4. Performances				
4.1	Speeds	traction with/without load		km/h 12.5 / 11.5
		lifting with/without load		m/sec 0.30 / 0.48
		lowering with/without load		m/sec 0.53 / 0.60
4.2	Tractive force	nominal 60' with/without load		DcN /
4.3	Max. tractive force	for 5' with/without load		DcN /
4.4	Gradeability	nominal 30' with/without load		% /
4.5	Max. gradeability	for 5' with/without load		% 13 / 20
4.6	Acceleration time	from 0 to 10 m with/without load		sec /
5. Weight				
5.1	Total weight	battery included		Kg. 3.350
5.2	Axle loading	with load forward/backward		Kg. 2.908 / 1.846
		without load forward/backward		Kg. 1.200 / 2.150
6. Motors - Battery				
6.1	Battery	voltage	V	48
		capacity	Ah	450
		min. weight	Kg.	730
6.2	Electrical motors	traction ( S2 - 60' )	KW	4.5
		lifting ( S3 - 20% )	KW	9
		servo steering	KW	0.5
6.3	Hydraulic pressure	max. pressure		bar 160
6.4	Noise Level	operators place		dB < 70

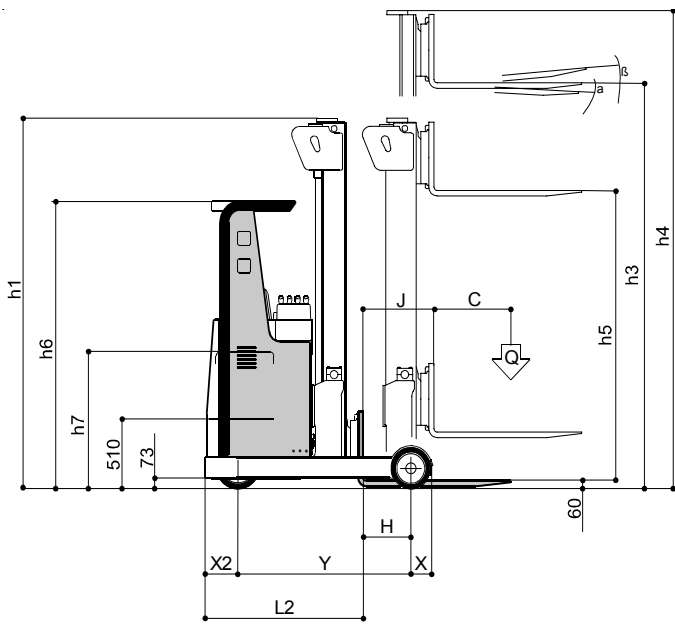

<b>x2</b>	back protection part	mm	<b>254</b>
<b>X</b>	load distance from center of front axle	mm	<b>170</b>
<b>H</b>	forks surface distance from front axle	mm	<b>376</b>
<b>Y</b>	wheel base	mm	<b>1.346</b>
<b>L2</b>	length overall including forks face	mm	<b>1.224</b>
<b>J</b>	mast advancement	mm	<b>550</b>
<b>B</b>	overall width	mm	<b>1.270</b>
<b>N</b>	forks outside maximum dimension	mm	<b>770</b>
<b>M</b>	distance among spokes	mm	<b>948</b>
<b>I</b>	forks length	mm	<b>1.150</b>
<b>c</b>	distance to load center	mm	<b>600</b>
<b>U</b>	front track	mm	<b>1.130</b>
<b>a/B</b>	tilting forward/backward	°	<b>3 / 5</b>
<b>a</b>	safety distance	mm	<b>100</b>
<b>Wa</b>	turning radius	mm	<b>1.600</b>
<b>Ast3</b>	stcking aisle	mm	<b>2.624</b>

Mast			duplex FFL	triplex FFL					
<b>h3</b>	lifting	mm	4.030	4.500	5.250	6.000	6.750	7.500	8.250
<b>h1</b>	min.height	mm	2.635	2.115	2.365	2.615	2.865	3.115	3.365
<b>h5</b>	full free lift	mm	1.985	1.560	1.810	2.060	2.310	2.560	2.810
<b>h4</b>	max. height	mm	4.585	5.095	5.845	6.595	7.345	8.095	8.845
<b>Q<sub>R</sub></b>	capacity	kg	1.400	1.400	1.400	1.400	1.400	1.250	1.0000
<b>c</b>	load center	mm	600	600	600	600	600	600	600



## C RT 14 Reach-Truck